

# FSB ROUND BASE ASSEMBLY

Great conversations start here.™

## PARTS LIST



(1) Base



(1) Column



(1) Tie Rod



(1) Top Plate



(1) Flange Nut



(1) Lock Washer

## TOOL LIST

Adjustable Wrench  
11/17 Socket Wrench

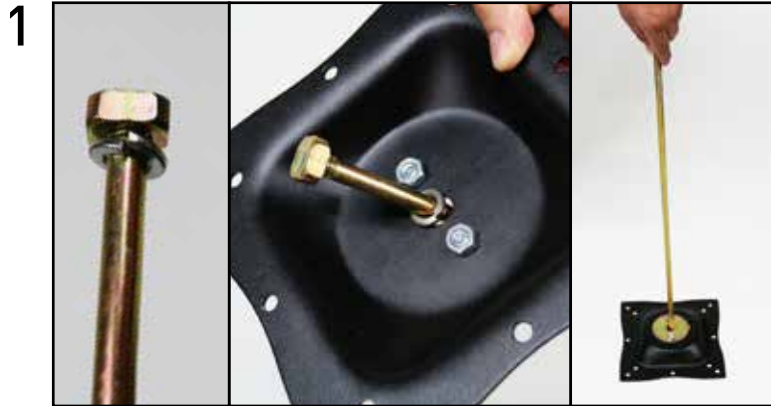

First slid the lock washer down the tie rod to the bolt side. Then thread the bottom of the tie rod, where the ridges are, through the middle hole of the top plate. Then place on the ground with the rod pointing upward



Place the column over the tie rod until it is securely placed on top of the top plate.

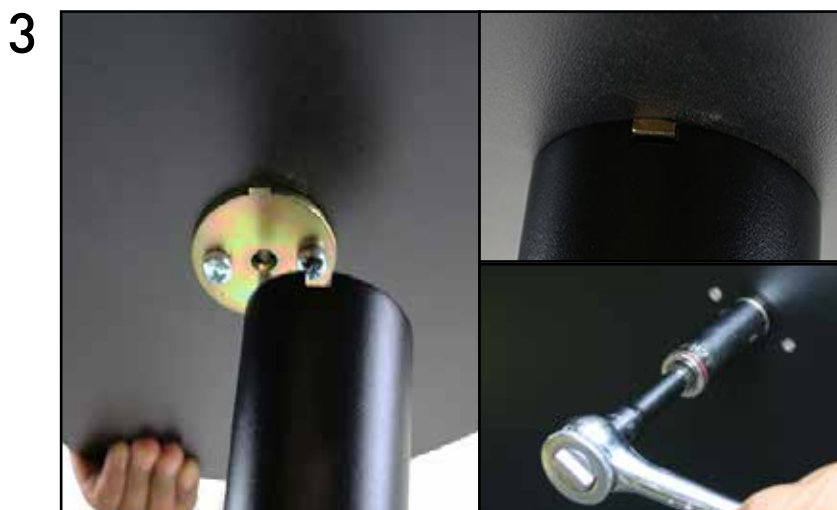

Place the base on the bottom of the column. The tie rod should come through the middle hole of the base. Line up the notches of the base and column. Then, attach the nut to the end of the rod and tighten with a socket wrench.

*\*Note this is a two person step, and is the same for square or round assembly.*

4



Finish by securely tightening base by using a 11/17 socket wrench to firmly tighten the keep nut on the bottom.

4cont.



Use an adjustable wrench on the top plate to hold the tie rod in place while tightening the keep nut.

*\*For a more permanently tight base, please use a drop of Loctite on the thread.*

5



Once base is secure, safely flip upright for final product.